



Battery Operated Ride-On Vehicle

Assembly Manual & User's Guide

Super Speed Off Road Racer

Model NO. 20013

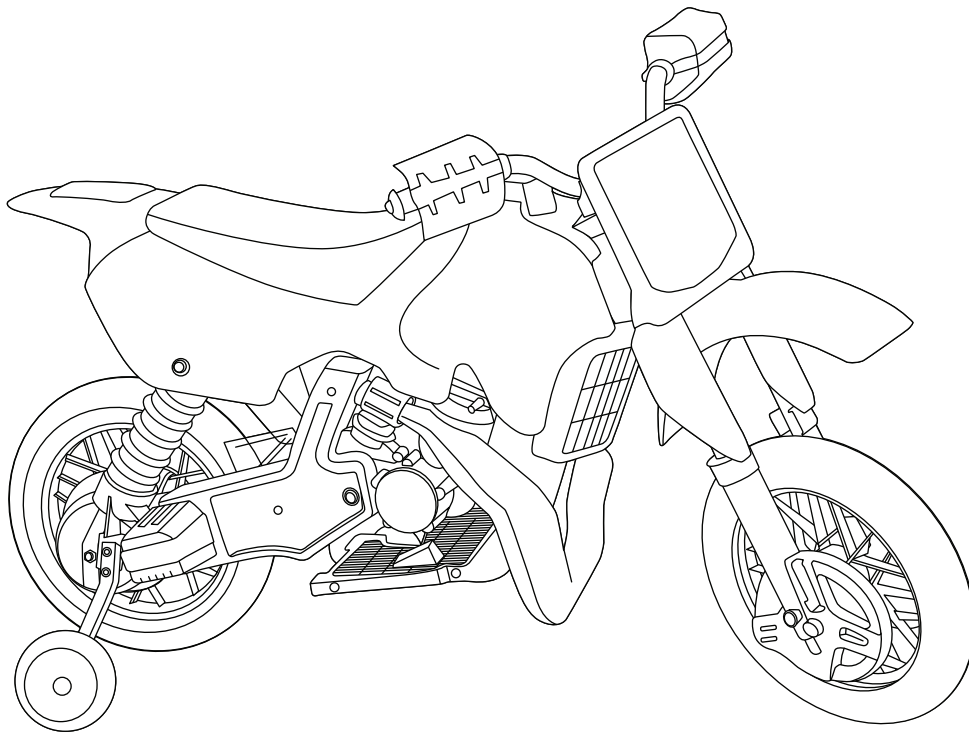

Adult Assembly Required

Please read this manual carefully before assembly and use.

Vehicle/Battery Specifications

Age:3-6 Year

Vehicle weight limit: 30kg / 66 Lbs

Speed:Max speed 3.0-3.5 KM/H; 2.5-3.0 MPH

Battery Type:Sealed lead-acid rechargeable,12 volt 7ah

Charging time:Always charge the battery for 8-10 hours before first use
and when recharging is needed.Never charge over 20 hours.

Battery Life:Recharging about 300 times.

Power input for Charger:A/C 120 volts 60HZ

Power output to battery:DC 14 volts,1000ma

Manufactured By:

Kalee Children' s Products Co.,Ltd

Wuli Industrial Zone, Jinjiang, Fujian, China

<http://www.kalee.com>

PARTS LIST:

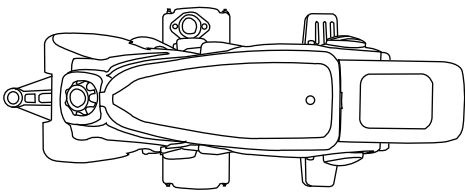

1 Main Chassis/Frame Assembly

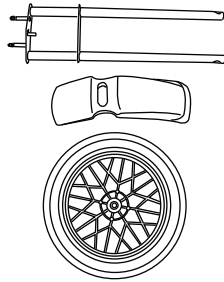

1 Front Fork
1 Front Fender
1 Front Wheel

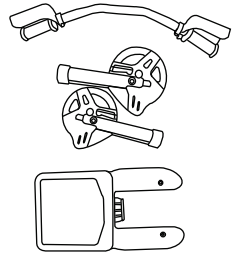

1 Handlebar
1 Number Plaque
2 Front Wheel Hubs

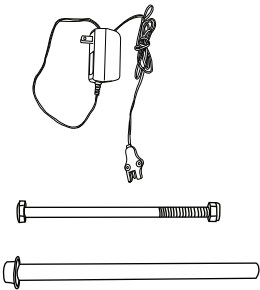

1 Charger
1 Front Fork Pivot Bolt With Nut
1 Front Axle
Package in Polyfoam

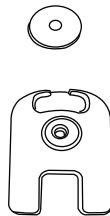

1 Round Upper Pivot Bolt Spacer
1 U-shaped Lower Pivot Bolt Spacer

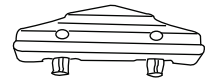

1 Plastic Front Fork cap

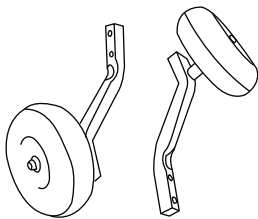

2 Training Wheels

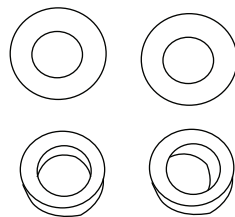

2 Washers
2 Black Plastic Axle Spacers

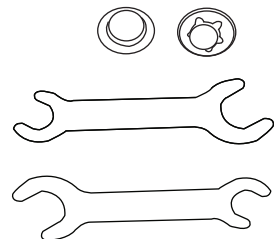

2 Axle Cap Nuts
2 Wrenches
Package with Manual and Warranty Card

How To Assemble The Vehicle:

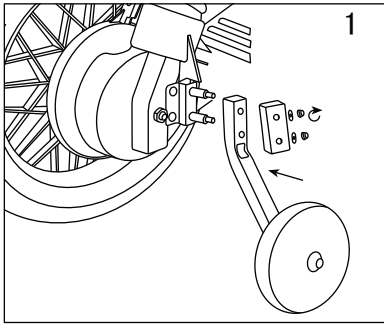

1. Install training wheels. Remove the 2 nuts and the plastic cap on the rear wheel supports. Put training wheel over the 2 studs, then put plastic cap over studs and tighten nuts. Repeat on opposite side. (Fig 1)

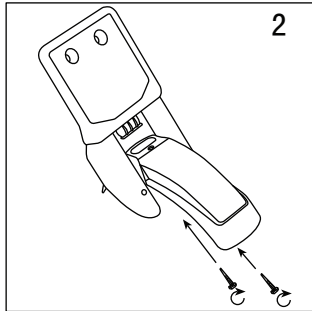

2. Snap front fender between the legs of the number plaque. Be sure to position fender with the long end towards the front. (Fig 2)

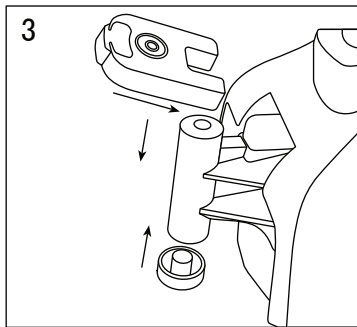

3. Put round pivot spacer on bottom of pivot shaft. Place U-shaped spacer on the top of the pivot shaft. (Fig 3)

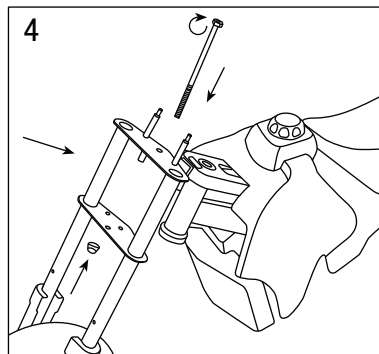

4. Align front fork with the pivot shaft. Insert pivot bolt through the assembly and tighten nut securely. (Fig 4)

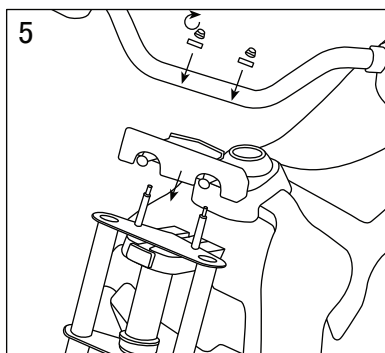

5. Put front fork cap over the 2 studs on top of the front fork. Then put the handlebars over the 2 studs. Put loc washers and nuts on studs and tighten securely. (Fig 5)

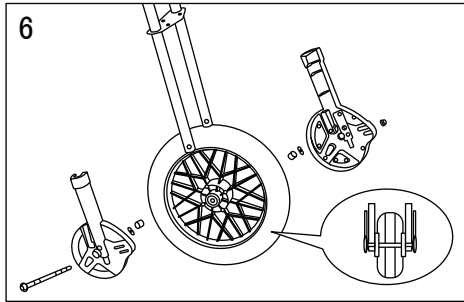

6. Snap front wheel hub cover onto fork leg. Be sure to line up hole for axle with fork. Repeat on other side. (Fig 6)
- Position the front wheel between the front fork. Insert the axle through the fork leg, place a metal washer, then a plastic spacer on the axle. Then push axle through the wheel. As axle exits wheel place a plastic spacer then a metal washer over the axle. Proceed through the fork leg attach the cap nut on the end of axle. (Fig 6)

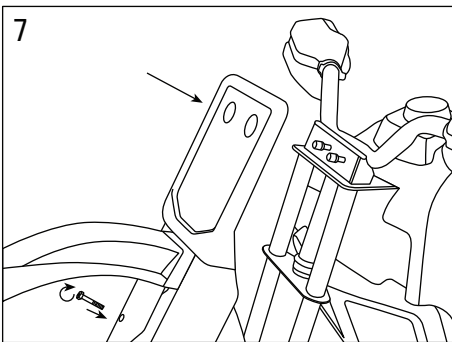

7. Snap the front fender assembly onto the front fork and tighten the 2 phillips screws. Do not over tighten. (Fig 7)

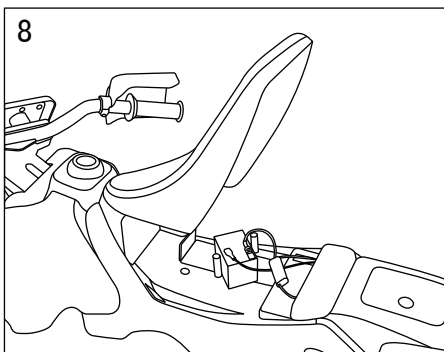

8. Before charging, remove the seat and check the battery connections. The red wire to the Pos red terminal and the black wire to the Neg black terminal. Note the fuse location. (Fig 8)

Operation of the Vehicle:

Press foot pedal, on the right, to move vehicle forward. Remove foot to stop vehicle. Rear light shines while vehicle is in motion.

Charging the Battery:

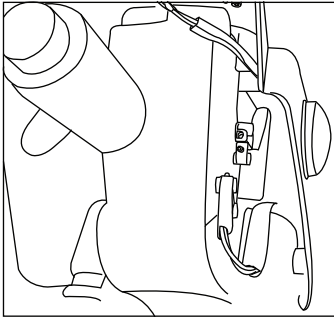

1. Locate the white plugs and red plugs under the rear fender. The white plug attached to chassis is to the battery. The red loose plug is to the motor.

2. Insert the red plug on the charger into the white plug for the battery. Then plug the charger into a household wall outlet.

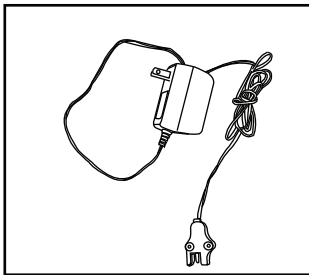

3. When charging is complete, unplug the charger from the wall outlet, then unplug from the battery plug. Connect motor plug to the battery plug.

4. To prolong battery life, you must recharge the battery after each use. You must also charge you battery if it has not been used for 30 days or more.

Battery/charger Safety and Warnings

- ◆ The charger is not a toy. The battery should be charged by adults only. Do not allow children to play with the charger or to recharge the battery.
- ◆ Before the first use, you should charge the battery for 8-10 hours. Do not recharge the battery for more than 20 hours to avoid overheating the charger.
- ◆ It is normal for the adapter to feel warm during charging, but if the charger feels very hot, stop charging, unplug charger and check the battery and adapter.
- ◆ When the vehicle begins to run slowly, recharge the battery.
- ◆ To lengthen the life of the battery, always charge the battery after each use and if not in use at least every 30 days.
- ◆ storing and at least every three months thereafter.
- ◆ Use only batteries of the same or equivalent type as recommended by the manufacturer.
- ◆ Do not connect the battery terminals directly together or the battery will short circuit.
- ◆ Charger should be examined regularly for damage to the cord, plug and other parts. If any damage is found the charger should be repaired or replaced immediately. Do not use a damaged charger.

 **WARNING**— Only use the charger specified by the manufacturer.

Caution

Your ride on toys is equipped with a built-in thermal circuit breaker. The thermal circuit breaker is a self-resetting safety device which automatically “trips” and shuts down the operation of the ride-on toy if it is overloaded or the driving conditions are too severe. Once the circuit breaker has tripped it will automatically reset itself after approximately 10 seconds and allow the rider to resume normal operation.

TROUBLESHOOTING

1) If vehicle fails to move:

- Make sure the battery wires are connected properly.
- Recharge the battery, if necessary.

2) If the vehicle runs slowly.

- Recharge the battery.

3) If the battery cannot be recharged:

- Battery or adaptor may be damaged. Replace if necessary.

If the vehicle still fails to operate properly, call our service center at 1-877-327-6098.

Vehicle Safety Warnings:

WARNING:

To reduce the risk of injury, adult supervision is required. Never use in roadways, near motor vehicles. On or near steep inclines or steps, swimming, pools or other bodies of water, always wear shoes, and never allow more than 1 rider.

- Use the toy only on flat surfaces, such as sidewalks, driveways or playgrounds. Do not ride the vehicle in dangerous places such as busy streets, roads or highways.
- Never use near swimming pools or other bodies of water.
- Never ride the toy in the mud or sandy areas. Never ride in hilly areas or on steep slopes. This vehicle was made to operate on dry level ground.
- Never ride in the dark or in dimly lit areas.
- Clean the vehicle only with a damp cloth and never submerge vehicle in water or spray with water from a hose.
- Only one child should ride this vehicle at a time.
- Do not exceed recommended weight limit.
- Please keep these instructions for reference about usage, storage and safety guidelines.
- If vehicle is equipped with forward/reverse switch, never press this switch while vehicle is in motion. Always stop the vehicle before switching directions.

WARNING

Contains small parts. Sharp points and sharp edges. Adult assembly required.

WARNING

Choking Hazard - Small parts
Not for children under 3 years old