

Assembly Manual & User's Guide

LITTLE INDIAN #30040

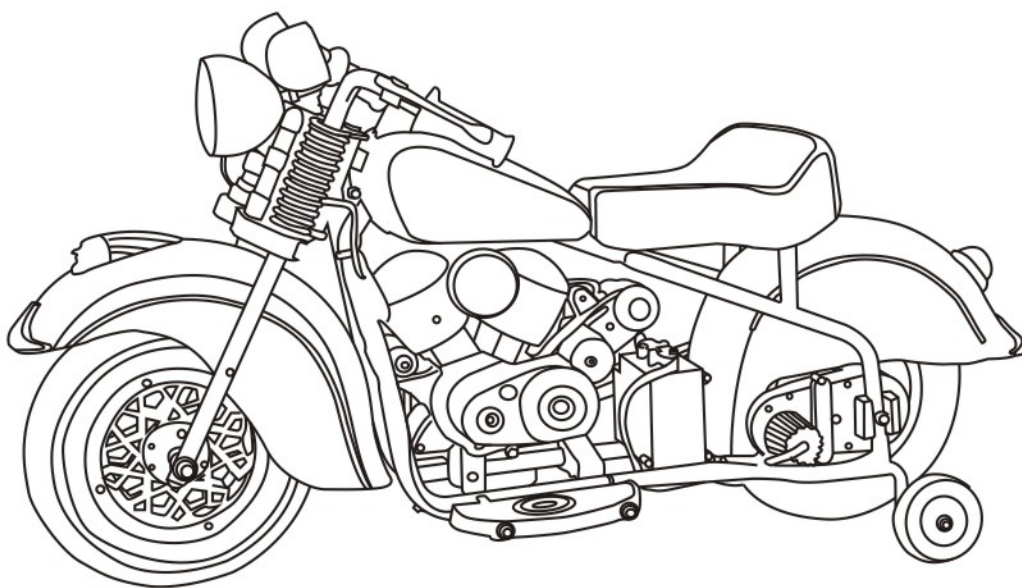

Adult Assembly Required
Please read this manual carefully before assembly and use.

Vehicle/Battery Specifications:

Age: 3-5 Years

Vehicle Weight Limit: 55 Lbs

Max Speed: 2 mph

Battery Type: Sealed lead-acid rechargeable, 6 volt 4ah

Charging time: Always charge the battery for 8-10 hours before first use and when recharging is needed. Never charge for more than 20 hours.

Battery Life: approximately 300 charges

Power input for Charger: A/C 120 volts 60hz

Power output to battery: DC 7.5 volts, 600ma

Manufactured By:

Kalee Childrens Products Co. Ltd.

Wuli Industrial Zone, Jinjiang, Fujian, China

<http://WWW.Kalee.com>

PARTS LIST:

1

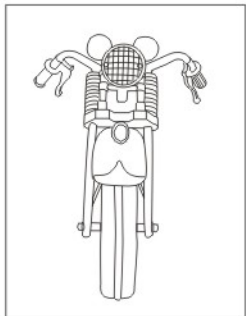

1 . Front Fork Assembly

2

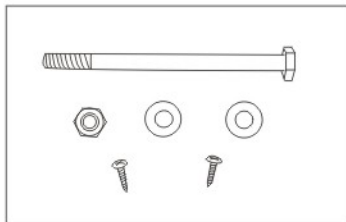

2. 1 Hex Bolt
w/ 2 Spacer Rings
1 Hex Nut
2 screws

How To Assemble The Vehicle:

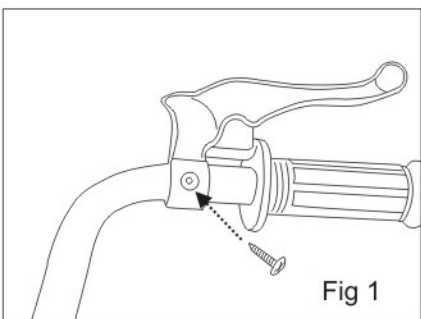

1. Insert the two screws into the left and right handgrips (fig 1) .

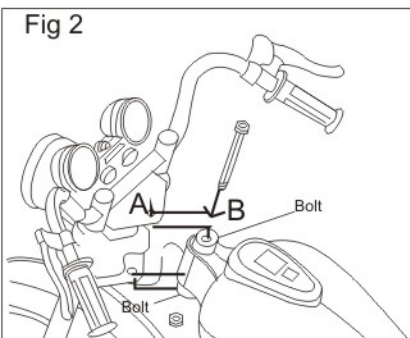

2. Connect the vehicle headlight wire to the corresponding body wire fig 3. Then align the holes in the front fork assembly with the holes in the vehicle body. Place the space rings, one on the top, one on the bottom. Then insert the hex bolt through the aligned holes, as shown in fig 2 and secure with the hex nut.

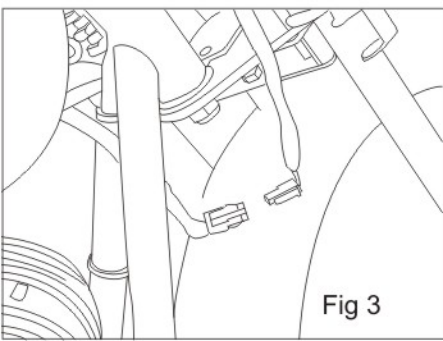

3. Locate the wires coming from the handlebar assembly and the bike and connect the terminals.

CHARGING THE BATTERY:

1. Battery is near the rear fender, white plug goes to battery, red plug goes to vehicle. Connect the white plug and red plug to play the vehicle.
2. When the battery is out of power, disconnect the white plug and the red plug, and then connect the red plug of the charger and the white plug of the battery, then plug the charger into a household outlet.
3. When charging is complete disconnect the charger from the wall outlet then reconnect the red plug of vehicle and the white plug of the battery.



White plug of the battery

Red plug of the vehicle

IMPORTANT: To prolong battery life, you must recharge the battery after each use. You must also charge your battery if it has not been used for 30 days or more.

OPERATION:

1. Press the forward/reverse switch to "F". Then step on the foot pedal, the vehicle will move forward and the headlight will shine. Remove your foot and the vehicle will stop.
2. Press the forward/reverse switch to "R". Then step on the foot pedal, the vehicle will move in reverse and taillight will shine. Remove your foot and the vehicle will stop.
3. Press the white button on the gas tank to hear the engine sound.

Battery/Charger Safety and Warnings:

- The charger is not a toy. The battery should be charged by an adult only. Do not allow children to play with the charger or to recharge the battery.
- Before the first use, you should charge the battery for 8-10 hours. Do not charge the battery for more than 20 hours to avoid overheating the charger.
- It is normal for the adapter to feel warm during charging, if the charger feels very hot, stop charging, unplug the charger and check the battery and adapter.
- When the vehicle begins to run slowly, recharge the battery.
- To lengthen the life of the battery, always charge the battery after each use and at least every 30 days when not in use.
- Use only batteries of the same or equivalent type as recommended by the manufacture.
- Do not connect the battery terminals directly together, this will cause the battery to short circuit.
- Charger should be examined regularly for damage to the cord, plug and other parts. If any damage is found, the charger should be repaired or replaced immediately. Do not use a damaged charger.



WARNING—

Only use the charger specified by the manufacturer.

Caution:

Your ride on vehicle is equipped with a built-in thermal circuit breaker. The thermal circuit breaker is a self-resetting safety device which automatically “trips” and shuts down the operation of the vehicle if it is overloaded or the driving conditions are too severe. Once the circuit breaker has tripped it will automatically reset itself after approximately 10 seconds and allow the rider to resume normal operation.

Troubleshooting:

1. If vehicle fails to move:
 - a) Make sure the battery wires are connected properly.
 - b) Recharge the battery, if necessary.
2. If vehicle runs slowly:
 - a) Recharge the battery.
3. If the battery cannot be recharged:
 - a) Battery or adaptor may be damaged. Replace if necessary.
4. If vehicle still fails to operate properly, call our service center at **1-877-327-6098**.

Vehicle Safety Warnings:



WARNING:

To reduce the risk of injury, adult supervision is required. Never use in roadways, near motor vehicles. On or near steep inclines or steps, swimming, pools or other bodies of water, always wear shoes, and never allow more than 1 rider.

- Use the toy only on flat surfaces, such as sidewalks, driveways or playgrounds. Do not ride the vehicle in dangerous places such as busy streets, roads or highways.
- Never use near swimming pools or other bodies of water.
- Never ride the vehicle in the mud or sandy areas. Never ride in hilly areas or on steep slopes. This vehicle was made to operate on dry level ground.
- Never ride in the dark or in dimly lit areas.
- Clean the vehicle only with a damp cloth and never submerge vehicle in water or spray with water directly from a hose.
- Only one child should ride this vehicle at a time.
- Do not exceed the recommended weight limit.
- Please keep these instructions for reference about usage, storage and safety guidelines.
- If vehicle is equipped with a forward/reverse switch, never press this switch while vehicle is in motion. Always stop the vehicle before changing directions.



WARNING

Contains small parts. Sharp points and sharp edges. Adult assembly required.



WARNING

Choking Hazard - Small parts
Not for children under 3 years old